

BASIC FEATURES

VS-PUMP is a quiet, reliable, and versatile condensate pump. It is capable of meeting the condensate needs of the entire VSCM series ceiling mounted ventilators. This pump comes with brackets specifically designed to allow for simple and easy mounting to the CM unit.



PRIMARY PARAMETERS

Supplier Model Number	Aspen Pumps Maxi Orange
Weight	1 lb
Input Voltage	208 V / 240 V AC
Input Current - Max.	0.11 A
Power Consumption - Max.	16 W
Frequency	50/60 Hz
Max. Flow	35L/h @ 0 head
Max. Recommended Head	49' / 15m
Sound Level @1m	35 dB(A)
Max. Water Temp	104° F / 40° C
Discharge Tube Inner Diameter	1/4" / 6mm
IP Protection	IP21
Thermal Protection	Yes
Fully Potted	Yes
Self Priming	Yes

Flow Rate vs. Head

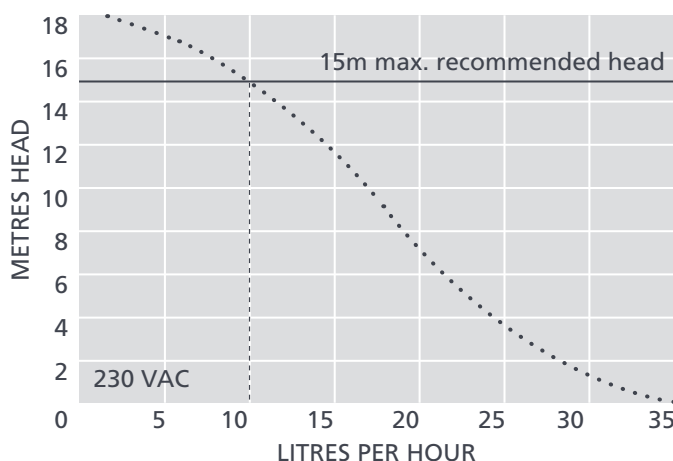

ADDED HEIGHT TO VSCM

Float	1.3"
Pump [Main Location]	2.7"
Pump [Alternate Location]	0"

See subsequent instructions, step 8.

DIMENSIONS

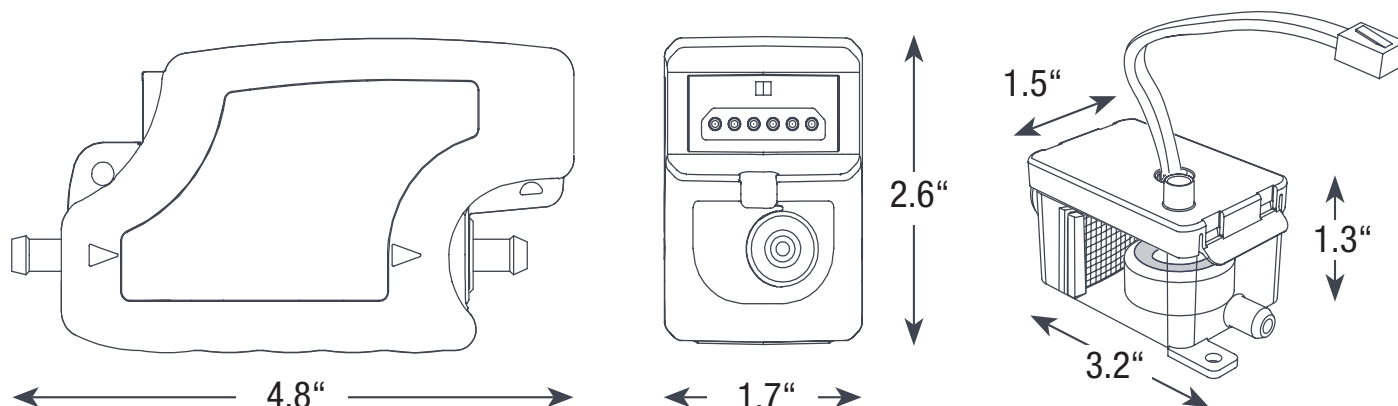

Rev 01.01

COMPONENTS

Pump

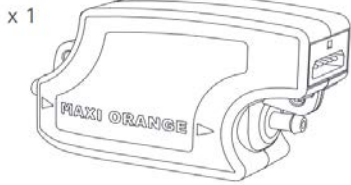

x 1

Float

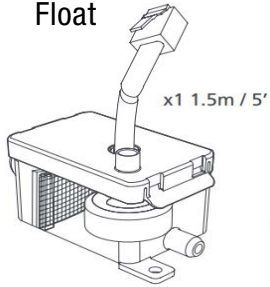

x1 1.5m / 5'

Short Clear Tubing

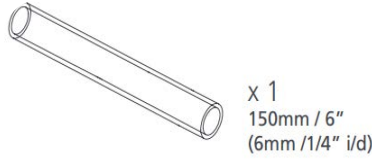

x 1
150mm / 6"
(6mm / 1/4" i/d)

Orange Hose

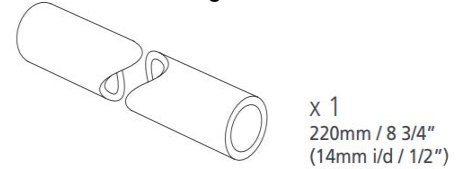

x 1
220mm / 8 3/4"
(14mm i/d / 1/2")

Pump Bracket

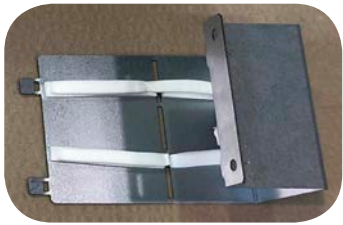

Float Bracket

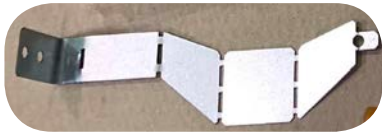

Long Clear Tubing

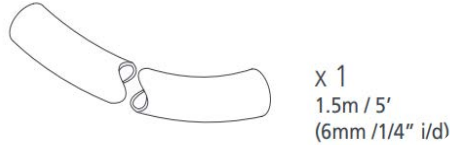

x 1
1.5m / 5'
(6mm / 1/4" i/d)

Black Hose Elbow

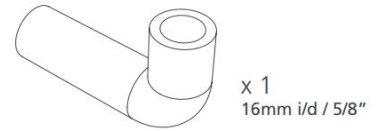

x 1
16mm i/d / 5/8"

Power Cable

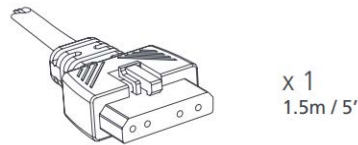

x 1
1.5m / 5'

Hose Connector

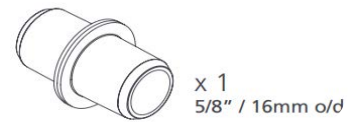

x 1
5/8" / 16mm o/d

TUBING CONNECTION OVERVIEW

See subsequent pages for detailed instructions

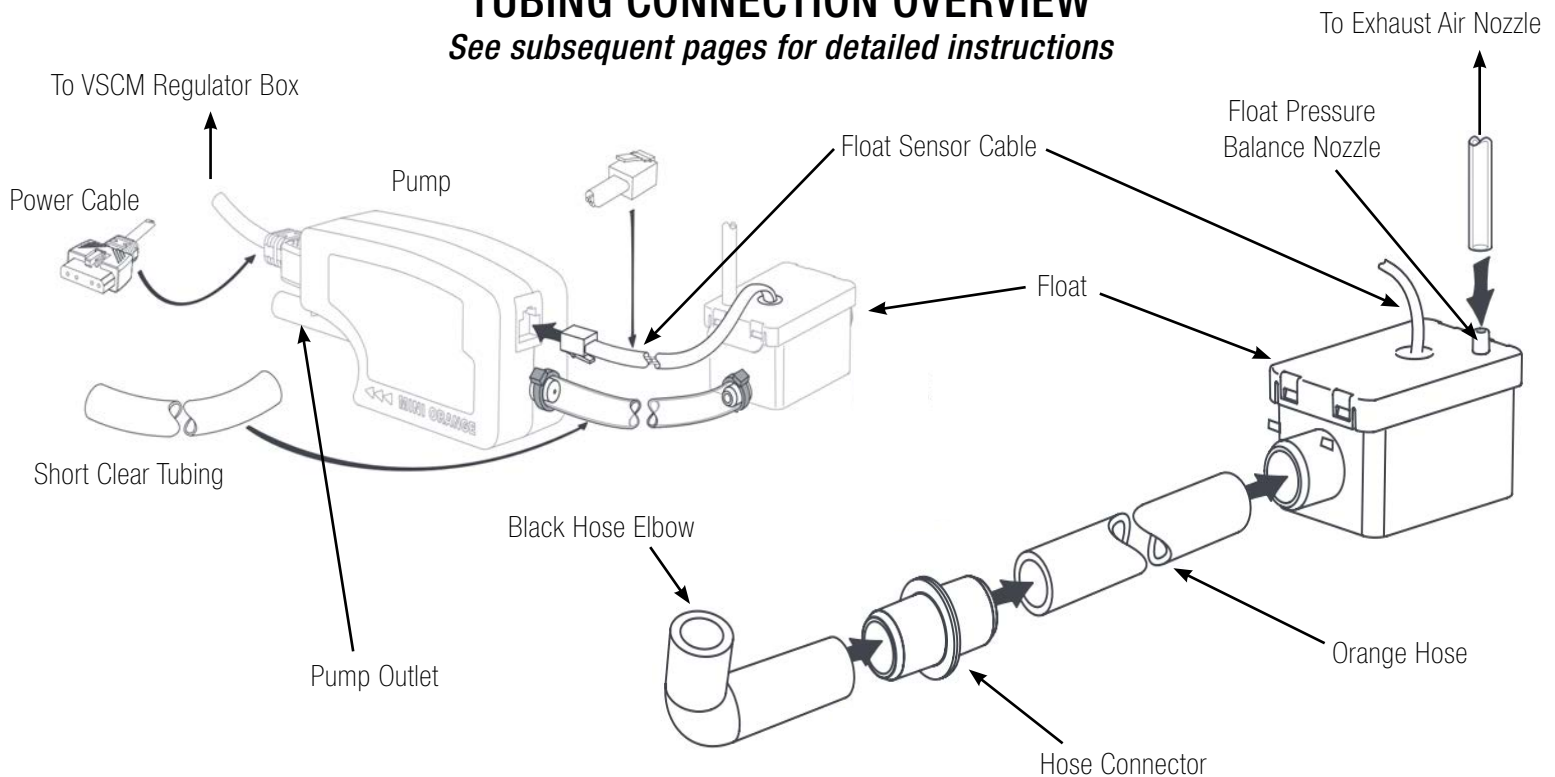

MOUNTING & WIRING THE PUMP

1. Power the unit off.
2. Place the pump in the pump bracket as illustrated in the image.
3. Fold the bracket flap over the pump.
4. Insert the tabs into the corresponding slots.
5. Bend the tabs down to secure the pump in the bracket.
6. Place the float on the float bracket as illustrated in the image.
7. Fold the bracket flaps over the float and insert the tab in the corresponding slot. Fold the tab down to secure the float in the bracket.
8. Choose between two pump mounting locations as illustrated in the image. For this document, the mounting location will be the location boxed in **red**.
9. Mount the pump / bracket assembly to the pump mounting location. Mount the float / bracket assembly to the float mounting location.
10. Connect the float's sensor cable to the pump.

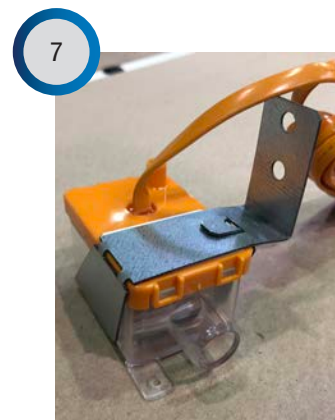
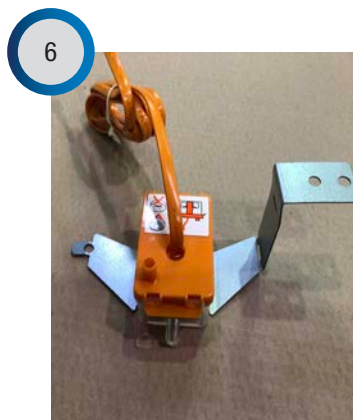
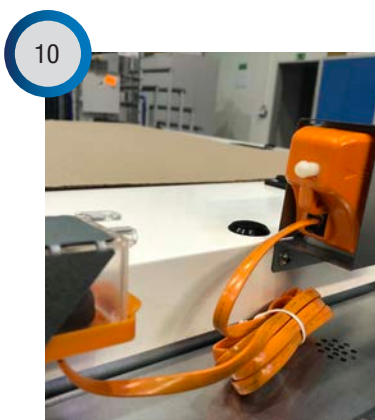
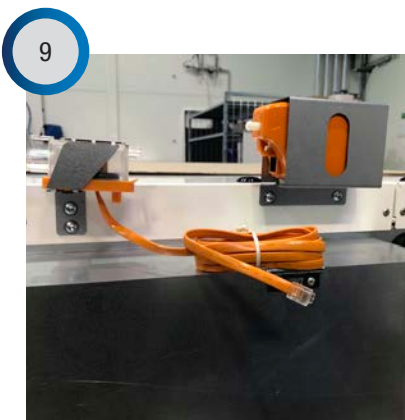
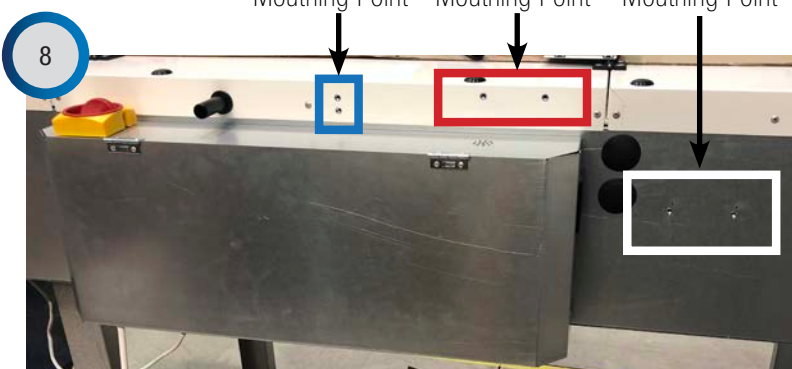
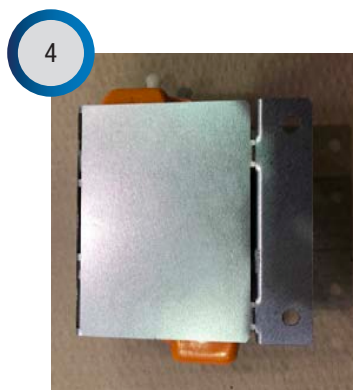
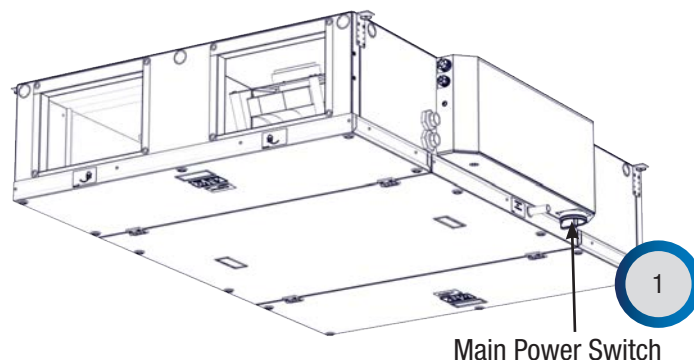

MOUNTING & WIRING THE PUMP

11. Insert the connector into the black hose elbow and insert the VSCM condensate drain outlet pipe to the black hose elbow. Connect the orange hose to the hose connector, joining with the black hose elbow. Cut the orange hose to length for connecting to the float and connect the orange hose to the float.
12. Connect the short clear tubing to the float. Cut the short clear tubing to length for connecting to the pump, and connect the short clear tubing to the pump, joining the float and the pump.
13. Remove the black plug on the exhaust air nozzle.
14. Connect the long clear tubing to the exhaust air nozzle.
15. Cut the long clear tubing to length for connecting to the pressure balancing nozzle on the float. Connect the tubing, joining the exhaust air nozzle and the pressure balancing nozzle on the float.
16. Use the excess long clear tubing (or desired tubing supplied by customer/contractor) to connect to the outlet of the pump. This tubing is to be routed to building drainage.
17. Connect the power cable to the pump.
18. Route the power cable through a cable gland into the regulator box.
19. Remove the wire duct cover and route the power cable through the wire duct.
20. Re-install the wire duct cover.
21. Terminate the brown wire to the terminal block labeled „Lpump.“ Terminate the blue wire to the blue terminal blocks.
22. Alternate mounting location for the pump. This location can be advantageous if the unit has to maintain a minimal clearance.

